

# Sanda Public Community Center

2021.4

< Sanda Ekimae Ichibankan, Kippy Mall 6th floor >



We are striving for being the base to promote forming a cooperative community and also to promote the mutual exchange among citizens while we support various civil activities generally.

## 6F Floor Map

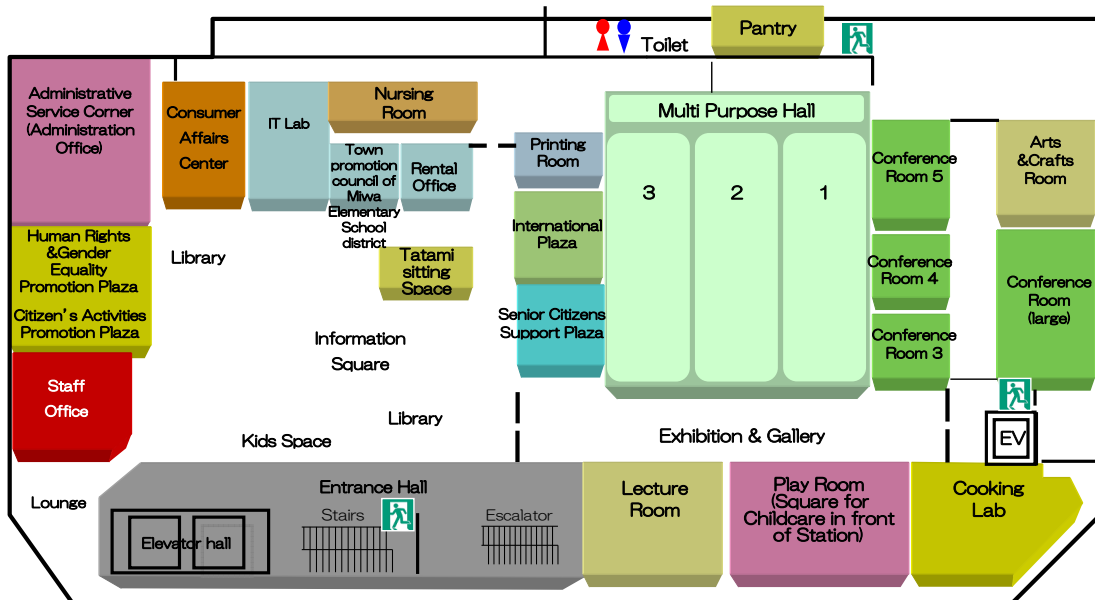

JR Sanda

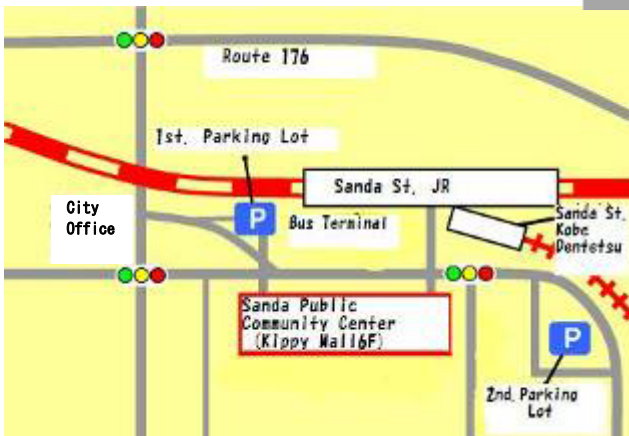

<Closed>  
29 Dec. ~ 3 Jan.  
(It may be closed extra.)

<Access>

Nearby JR Sanda Station, Kobe Railroad Sanda Station  
(Pedestrian deck links to JR Sanda Station)

<Parking>

The First parking lot (about 210 cars)

Free ---- up to 2.5hr for the user of this Center

The Second parking lot (about 360 cars)

Free ---- up to 3.5hr for the user of this Center

★Bring a parking ticket to the Staff Room of the center  
for this service.

Sanda Public Community Center  
Location/ Ekimae-Cho 2-1, Sanda City,  
Sanda Ekimae Ichibankan (Kippy Mall 6F)  
Floor Space/6F 3019.5 m<sup>2</sup>

# Information on Use of Sanda Public Community Center

## Rental facilities

10:00-22:00 (Weekdays, Saturdays, Sundays and public holidays)

Facilities name		Capacity(person)	Standard rental fee (30 minutes)
Multi-purpose Hall	All rooms	270 persons	2,400 yen
	2/3	180 persons	1600 yen
	1/3	90 persons	800 yen
Lecture room		36 persons	650 yen
Conference room (Large)		24 persons	250yen
Conference room 3		12 persons	100yen
Conference room 4		12 persons	100yen
Conference room 5		18 persons	150yen
Play room		※	350yen
Cooking Lab		18 persons	400yen
Arts & Craft Room		12 persons	200yen
Pantry (table setting preparation room)		—	100yen
Exhibition & Gallery		500yen per a day (one section)	
Rental Office (only registered organization)		5000yen per a month	
Rental P.C.		Free(The printers are charged)	
Copy		Chargeable	

※The rent varies when the facilities are rented by other people than citizens or for commercial purposes. Please ask the staff room for the details such as the application method and use regulations, etc.

※The play room has the capacity of 30 persons in case it is used for a meeting such as a conference. It is available from 10:00 to 22:00 on every Monday, Friday, and Saturday, and it also is available from 18:00 to 22:00 on every Tuesday, Wednesday, Thursday, and Sunday when "Square for Childcare in front of station" is held.

※Smoking is prohibited.

### Civic activities are supported in various manner.

- The registered organizations can rent chargeable facilities such as the multipurpose hall, the lecture room, and the conference room at half the standard rent, and also can reserve temporarily one month earlier than general public. Please look at "Handbook for use of charged-facilities" for details at the staff room.
- There are also the kids corner (no charge) and the play room (chargeable) to help support activities of the people accompanied by children. (For example, a cooking course can be carried out in the next cooking practical room while a short time nursery care is given to children at the play room. )
- Picture editing with the personal computer of IT lab, and the printing machine (a color copying) can be used to make an activity more efficiently (chargeable) .
- There is also a space, which can be used free, such as workspace, library, and tatami sitting space.

### Administrative Service Center (Administration Office)

10:00-18:00 (Weekdays, Saturdays, Sundays and public holidays)

- Receipt of public charges such as the municipal tax and water charges. (This service is available only to those who come to this office with the statement of payment before or on the due date of the payment. )
  - Municipal government policy guidance, sale of the specified garbage bags and of the city publications and the issuance of the maternity record book.
  - Citizen consultation business (legal aid services, administrative counseling, consultation for a woman, etc. )
  - Promotion of international exchange programs and of a multicultural symbiosis enterprise
  - Promotion of gender equality
- ※Please ask about the date, time and the method of application for a consultation, like the legal aid service (including if or not an appointment is necessary). Your confirmation is possible on the city website.

### In each of the plazas, various information is offered.

**Civic- activities Promotion Plaza TEL079-559-5168**

**Human Rights and Gender Equality Promotion Plaza  
TEL079-559-5163**

**Weekday 10:00-12:30, 13:30-17:00 \*Advance reservations required.  
(Every Monday online consultations about community activities are available via Zoom)**

Supporting those who participate in or want to start community activities and providing them with a wide variety of information on topics including human rights and gender equality.

**International Plaza TEL079-559-5164**

**10:00-12:30, 13:30-17:00 (Closed on Tuesday)**

The information on the introduction of international exchange programs is offered. Also, this plaza offers an opportunity to support foreign residents or the information necessary for their living.

**Senior Citizens Support Plaza (Weekday 10:00-17:00)**

**TEL079-559-6800**

Integrated window

**Consumer Affairs Center Consultation TEL 079-559-5059**

**TEL079-559-5032**

This center offers the information about the consumers' daily life for the safe and carefree living.

Open: Weekday, 2nd and 4th Saturday (except holiday and Sunday)

10:00-18:00, Consultation 10:00-17:00

**Square for Childcare in front of station TEL 079-556-5230**

This is the space where child-rearing parents and children can drop in freely to play with toys and picture books, etc. Guardians also can find friends and exchange information.

Open: every Tuesday, Wednesday, Thursday, and Sunday. 10:00-17:30

## Sanda Public Community Center

〒669-1528 Ekimae-cho 2-1, Sanda City, Sanda Ekimae Ichibankan (Kippy mall) 6<sup>th</sup> floor

Staff Room (management of rental facilities in the hall) TEL079-559-5155 FAX.079-559-5161

Administrative Service Corner (Administration Office) TEL.079-559-5154 FAX.079-563-8001

【City Homepage Address <http://www.city.sanda.lg.jp/>】